



2020-2021 Ford Explorer K9 Platform Assembly/Installation Instructions

American Aluminum

www.EZRiderOnline.com

3882 U.S. Hwy 19 South

Perry, Florida 32348

PH: 1-800-277-0869

Fax: (850)-584-8485

Please read and fully understand assembly instruction before installing the unit

For Assistance Call 1-800-277-0869

Please review and double check the unit's Inventory checklist to make sure all components are included



READ ANY AND ALL
INSTRUCTIONS BEFORE
CONDUCTING INSTALL /
REPLACEMENT

FAILURE TO FOLLOW
INSTRUCTIONS CAN LEAD
TO INJURY AND / OR
DAMAGE OF PRODUCT

USE APPROPRIATE
PERSONAL PROTECTIVE
EQUIPMENT WHEN
CONDUCTING INSTALL /
REPLACEMENT

CONTACT AMERICAN
ALUMINUM /CAMLOCKER AT
(800) 277-0869 WITH ANY
QUESTIONS BEFORE
PROCEEDING

Rubber pan mat must be completely dry before laying it on the pan after every wash to prevent water damage to the Powder Coat on the Pan

ATTENTION

Important Information!

- Prior to Installation, First remove the rear seating. While removing the rear seating **DO NOT** unhook the wiring harness going to each female seat belt buckle. The buckles will need to stay connected to the wiring harness to insure no vehicle error codes.
- Due to the door panel design of the 2020 Explorer the speaker pod will need to be removed. This also allows the K9 user to have more useable floor space in the K9 unit. The speaker pod can be reinstalled at a later date if needed.
- We utilize a clear polycarbonate material to fill in the gaps between the outside edge of the K9 unit and the interior of the vehicle at the door opening. This will be important in the case of an accident. The polycarbonate is designed to allow the side curtain airbag to deploy while also adding a layer of protection for the high energy K9.
- 8 holes have been pre punched to assist with the mounting of our gas strut for our Cool Guard System with Rescue. Two in each door panel and two on each side of the inner wall of the front partition. If the Cool Guard Rescue gas strut is not being installed we have included 8 rivets in the supplied hardware kit to fill the blank holes.

Step #1 Installing the Pan

Prior to installing the pan you will need to trim the foam under the false floor.

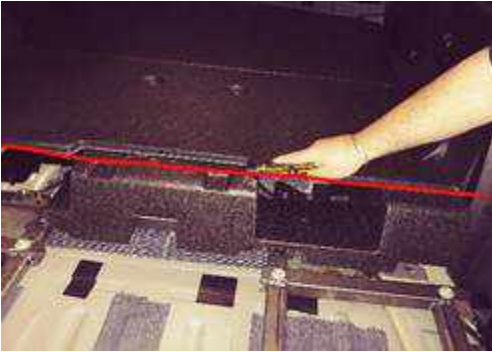

You will also need to bundle your seat belt buckle and wire pigtail together with a zip tie and tuck them out of the way.

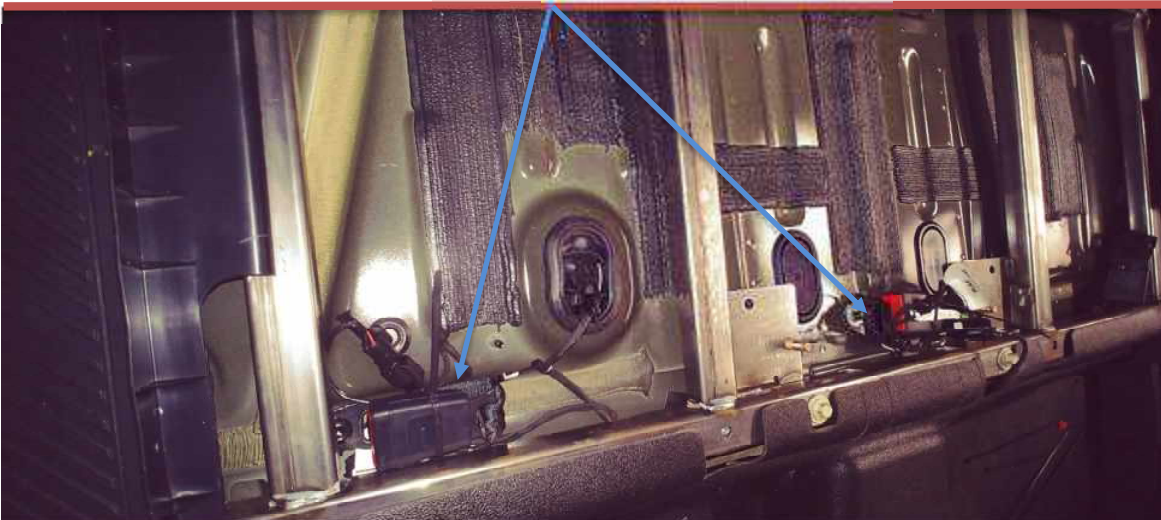

DO NOT DISCONNECT THE SEATBELT WIRING!!!

Now that the prep work is done you will need to attach the pan brackets.

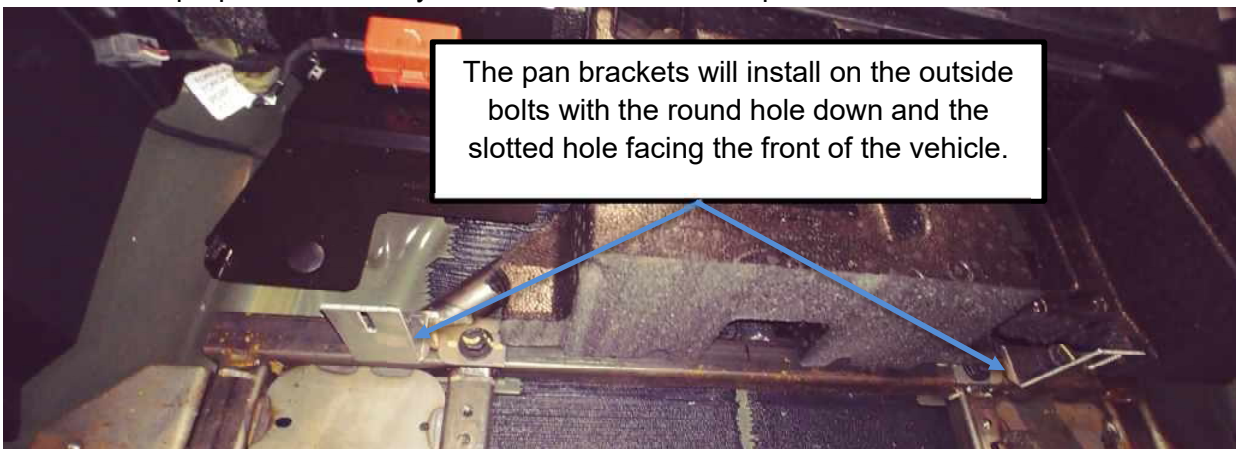

The pan brackets should be tightened down.

The pan can now be placed in the vehicle. Once the pan is placed in the vehicle push down on the pan at the door jambs to make sure it's seated down completely.



With the vertical slot of the pan bracket and the horizontal slot of the pan lined up place a 5/8" 1/4 #20 bolt with a washer through and attach supplied lock nuts.

NOTE: Don't tighten bracket nut and bolt completely till the install is complete.

Step #2 Installing the Back

Once the Pan is installed find the K-9 Back and set it on top of the pan in front of 2" lip and line the predrilled holes of the back with the nut inserts in the back lip of the pan. This will use 10 ea. 3/4"x 1/4" bolts with washers.



The K9 Back sits on the inside of the pan

When installing the back you'll want to get the outside wing bolts started first. Once the four outside bolts are started get the other six bolts started. Make sure to get all the bolts started before tightening any completely.

STEP #3 Installing the Front

Position the K-9 Front on the front of the Pan behind the 2" lip with the door facing the front of the vehicle. Align the predrilled holes (nut inserts) of the front with the holes in the pan and fasten them together with 4 ea. $\frac{3}{4}$ " x $\frac{1}{4}$ " Hex head bolts.

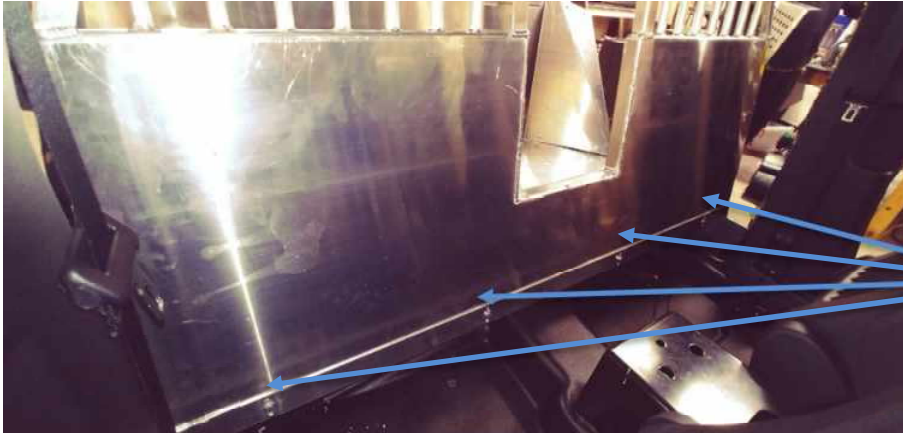

Make sure to get all four bolts started before tightening any of them completely.

Step #4 Installing the Roof

Install the roof (canopy) on top of the unit. The Front and back will have predrilled holes that line up to the holes in the canopy. Use $\frac{3}{4}$ " x $\frac{1}{4}$ " Hex bolts, locknuts and washers for all holes on the top and the corners.



Step #5 Installing the Grab Handle Bracket



You'll need to remove the factory grab handle. The bracket will be mounted with the factory 10mm grab handle bolt. The rear facing edge of the bracket should line up flush with upper frame of the front. You will then need to drill through the bracket and front. You will then bolt them together $\frac{5}{8}$ " x $\frac{1}{4}$ " #20 hex bolt and locking nut.

Step #6 Installing the Polycarbonate (Poly)

Attach the front Poly using 2 each 5/8 X 1/4 #20 hex bolts and washers. Attach the rear poly using 4 each 5/8 X 1/4 #20 hex bolts and washers.

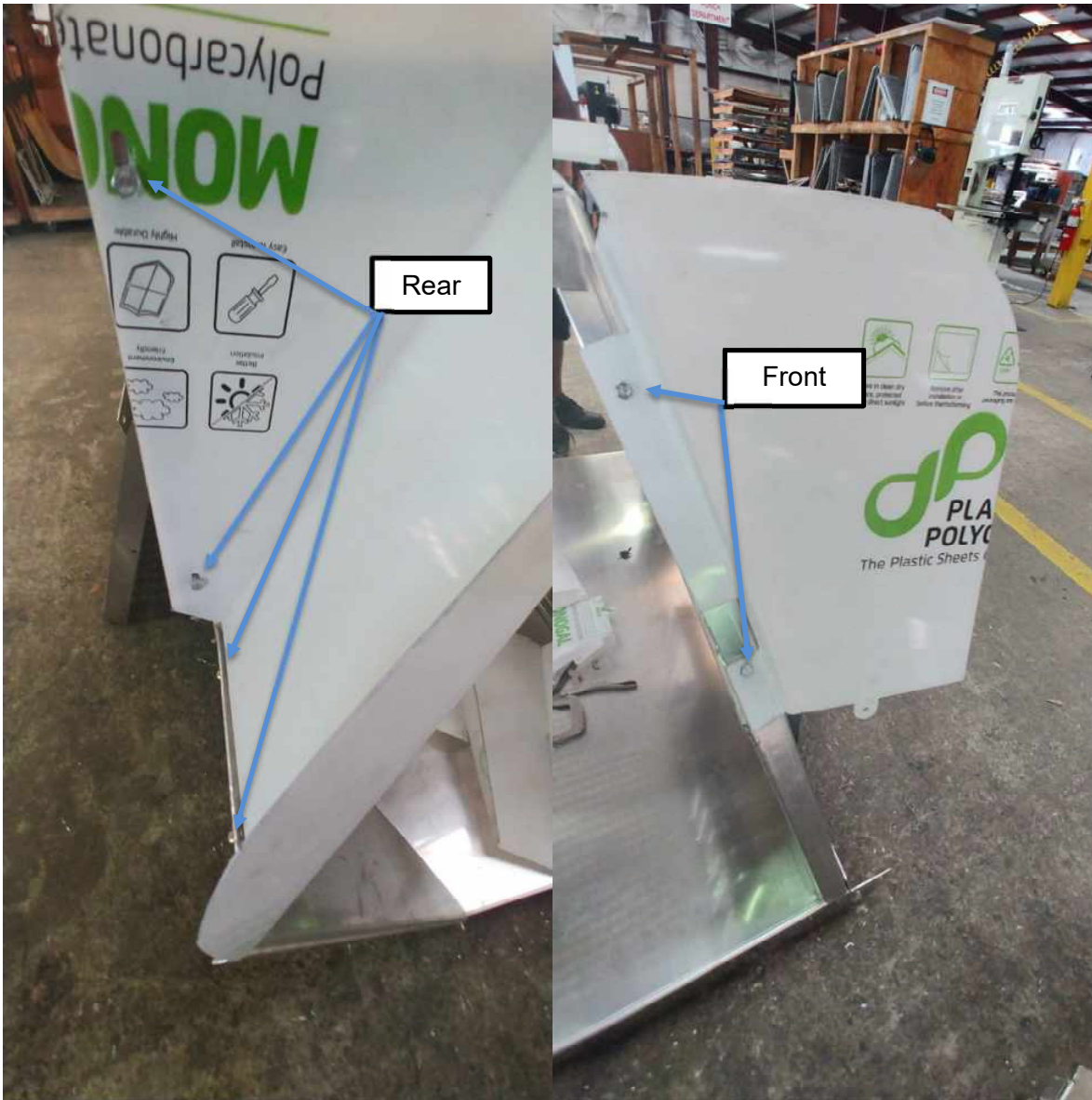

To install the polycarbonate headliner cover you will need to hold the headliner cover in place with the pointed end facing the rear of the vehicle and mark the hole placement. Drill where marked. Attach using 2 each 5/8 X 1/4 #20 hex bolts and washers with lock nuts.

The tab on the headliner cover goes over the front wing.



Step #7 Installing the Black Rubber Poly Trim

You will need to start installing the trim on the bottom of the rear poly wing. Continuing along the upward edge until the two poly parts come together.



Once you have the rear wing trimmed you'll need to continue running the trim from the rear poly to the headliner cover poly. Then down the length off the headliner cover.

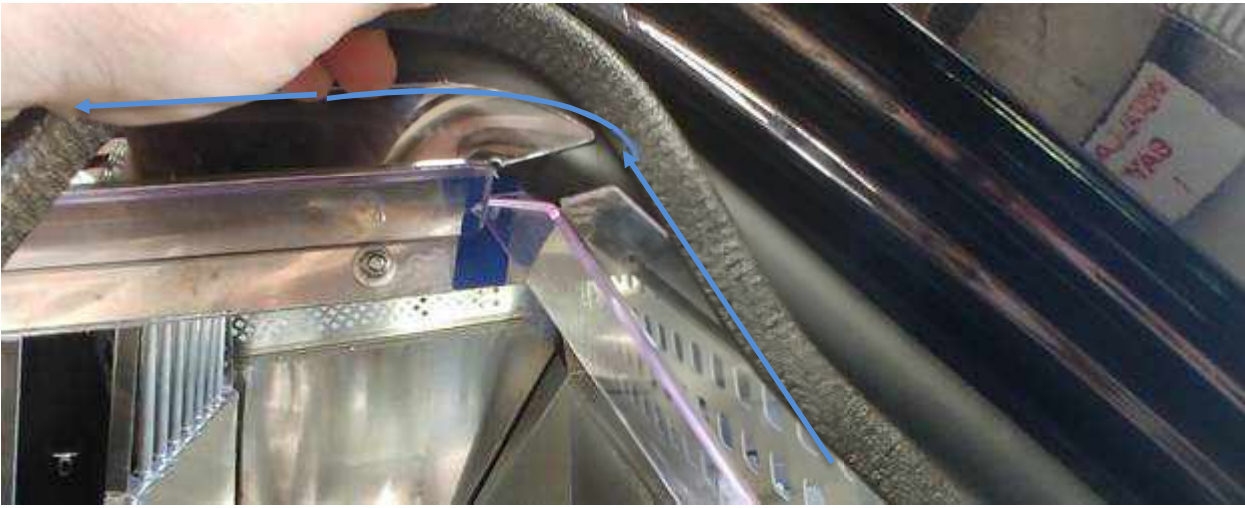

You will continue to run the trim to the end of the headliner cover and continue the trim onto and down the front polly.



With the trim fully installed you should have a finished look as shown in the photo below.



Step #8 Installing the Front Filler Wing

You will now install the front lower aluminum wing. You'll want to position this wing to fill the gap between the front partition and the B-Pillar. Once you have the wing positioned to cover the gap you'll use 3 each 1" self-tapping screws to fasten the wing to the K9 front partition.



Utilize the three pilot holes
in the wing

Installing the Rubber Mat

Lay the rubber mat on top of the Pan



Rubber pan mat must be completely dry before laying it on the pan after every wash to prevent water damage to the Powder Coat on the Pan

Step #9 Removing the Factory Door Panels

Remove the factory Door Panels. The speaker pod will need to be removed. It will need to be cut around as the pictured yellow line shows. Making sure to leave three of the locking lugs attached to the speaker pod. This will allow the pod to be reinstalled if needed. You will also cut the stud ends pictured. You will cut them just above the nut.

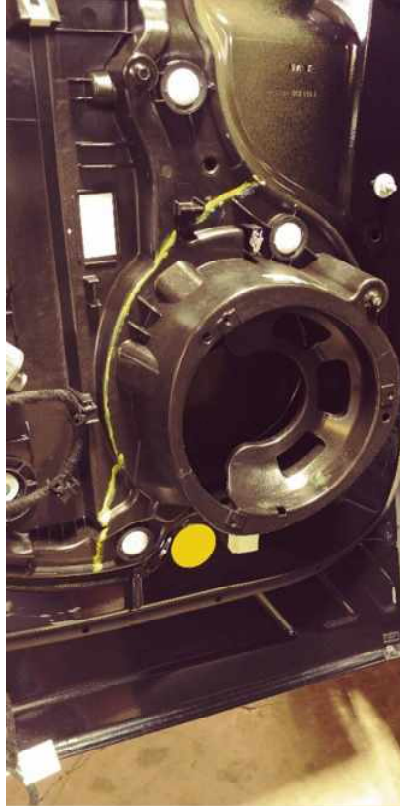

NOTE: It's recommended to use a die grinder with a cut off wheel to remove the speaker pod.

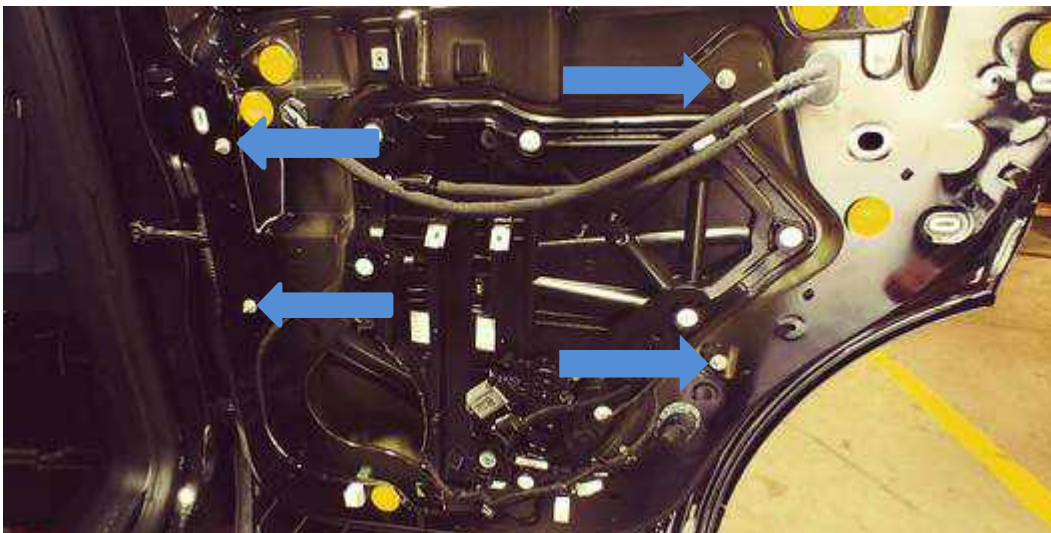

Step #10 Installing the Door and Window Panels

Position the door trim panels as shown in the below diagram. Using the Predrilled holes as a pattern mark the vehicle door frame for pilot holes that will be drilled. ****Only drill one on each side for now just to hold door panel in place****

(After you have two screws holding the door panel in place, set the window guard and check for proper alignment. The window guard will be hinged to the door panel once both are set with proper alignment.)

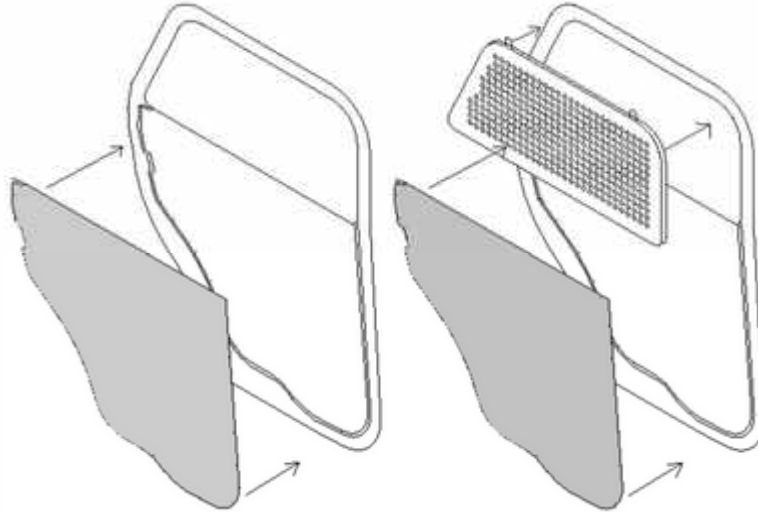

Once you have the Window Guards and Door Panels set with proper alignment. Check the holes that were marked for the door panel (Remark them if necessary) and drill the pilot holes using a 9/64" drill bit. Now fasten the door panel to the door frame using 16 ea. #8 x 3/4" screws. Set the window guards in place and connect the hinge that comes attached to the window guards to the door panels with 11 ea. #8 x 3/4". Now drill a pilot hole for each of the tabs on the window guard and fasten them down using the supplied 6 ea. # 8 x 3/4" Phillips Head screws. See picture below for completed door and window panels.

